

County Surveyor's Record, Tillamook County Oregon

CHAINS

ESTABLISHED CORNERS FOR OREGON STATE BOARD OF FORESTRY

South One Sixteenth corner common to Sections 1 & 6,  
T. 2N, R. 9 & 10W, W.M., Tillamook County, Oregon.

ESTABLISHED

Var. 21½E

Set 1½" x 36" galvanized iron pipe with 3" bronze cap marked "OREGON STATE BOARD OF FORESTRY S 1/16 S1 S6 1958 RS401," 34 inches in ground, in mound of stone on ~~W~~edge of 24" Alder uproot, and from which a:

31" Hemlock bears S32W 87.3 ft.; scribed S 1/16 S1 BT RS401.  
15" Hemlock bears N33W 68.5 ft.; scribed S 1/16 S1 BT.

Oregon State Board of Forestry metal location poster on 15" Hemlock BT.  
Set 4 x 4 x 60" white painted Cedar post 2.5 ft. West of pipe.

Center South One Sixteenth corner for Section 6,  
T. 2N, R. 9W, W.M., Tillamook County, Oregon.

ESTABLISHED

Var. 21½E

Set 1½" x 36" galvanized iron pipe with 3" bronze cap marked "OREGON STATE BOARD OF FORESTRY S 1/16 C--C 1958 RS 401," 33 inches in ground, and from which a:

23" Spruce bears S78E 85.2 ft.; scribed CS 1/16 S6 BT RS401.  
19" Spruce bears N73W 30.3 ft.; scribed CS 1/16 S6 BT.

Oregon State Board of Forestry metal location poster on 23" Spruce BT.  
Set 4" x 4" x 60" white painted cedar post 1.0' N.W. of pipe.

Dated February 19, 1958

Established by

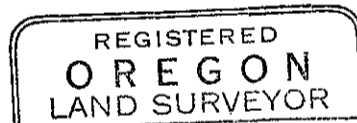

*Richard A. Morris*

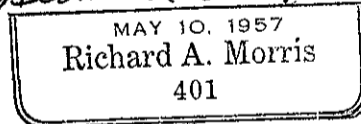

Present and witnessed by Robert Sturm  
Harold Russell

Book 1